



881L 330 kHz Echo Sounder  
445-078 MARCH 2011-REVISED MAY 2017

## IMAGENEX MODEL 881L 330 kHz DIGITAL ECHO SOUNDER

### APPLICATIONS:

- ROV, AUV & UUV
- Offshore Oil & Gas
- Surveying
- Underwater Archaeology
- Scientific Research

### FEATURES:

- Ethernet communications
- Programmable
- High performance
- Low power
- Simple set-up and installation
- 10 to 200 m operation
- Compact size
- Communication format available to user

The Imagenex Model 881L 330 kHz Echo Sounder is a completely self-contained echo sounder with Ethernet communications. It is mounted in a pressure-proof housing with an underwater connector for use in depths up to 1000 meters (~3000 feet). It can be used as a standard echo sounder or with digitized first returns only. Its requirements are minimal, needing only a power source and a digital interface to an external device such as a personal or laptop computer.



Picture shown with optional right angle connector.

| <b>HARDWARE SPECIFICATIONS:</b>            |  |
|--|--|
| <b>FREQUENCY</b>                           | 330 kHz  |
| <b>TRANSDUCER</b>                          | Conical  |
| <b>TRANSDUCER BEAM WIDTH</b>               | 20°(Standard)  |
| <b>RANGE RESOLUTION</b>                    | 10 m & up: 10 mm (0.4")  |
| <b>MIN. DETECTABLE RANGE</b>               | 1 m (39")  |
| <b>MAX. OPERATING DEPTH</b>                | 1000 m   |
| <b>MAX. CABLE LENGTH</b>                   | Standard: 100 m on CAT5e<br>Cable length may be increased up to ~9000 m using an Ethernet extender. Please enquire for more information. |
| <b>INTERFACE</b>                           | Standard: 10 Mbps Ethernet (10 BASE-T) using TCP/IP<br>Bit rate may vary if an Ethernet extender is in use.                              |
| <b>CONNECTOR</b>                           | Side mounted, eight conductor, wet mateable (Subconn MCBH8M-AS)<br>Optional right angle or end mount connector                           |
| <b>POWER SUPPLY</b>                        | 20 – 32 VDC at less than 3 Watts   |
| <b>DIMENSIONS (for both depth ratings)</b> | 79.4 mm (3.125") diameter x<br>139 mm (5.5") length  |
| <b>WEIGHT: In Air</b>                      | ~1.1 kg (2.3 lbs)  |
| <b>In Water</b>                            | TBA  |
| <b>MATERIALS</b>                           | 6061-T6 Aluminum & PVC   |
| <b>FINISH</b>                              | Hard Anodize   |

| <b>SOFTWARE SPECIFICATIONS:</b>                   | <b>Win881L_ES.exe</b>   |
|---|---|
| <b>WINDOWS™ OPERATING SYSTEM</b>                  | Windows™ XP, Vista, 7, 8, 10  |
| <b>MODES</b>                                      | Echosounder   |
| <b>RANGE SCALES</b>                               | 10 m, 20 m, 30 m, 40 m, 50 m, 60 m, 80 m, 100 m, 150 m, 200 m                     |
| <b>FILE FORMAT</b>                                | (filename).81L  |
| <b>RECOMMENDED MINIMUM COMPUTER REQUIREMENTS:</b> | 100 MHz Pentium<br>16 MB RAM<br>1 GB Hard Disk<br>800 x 600 x 256 colour graphics |

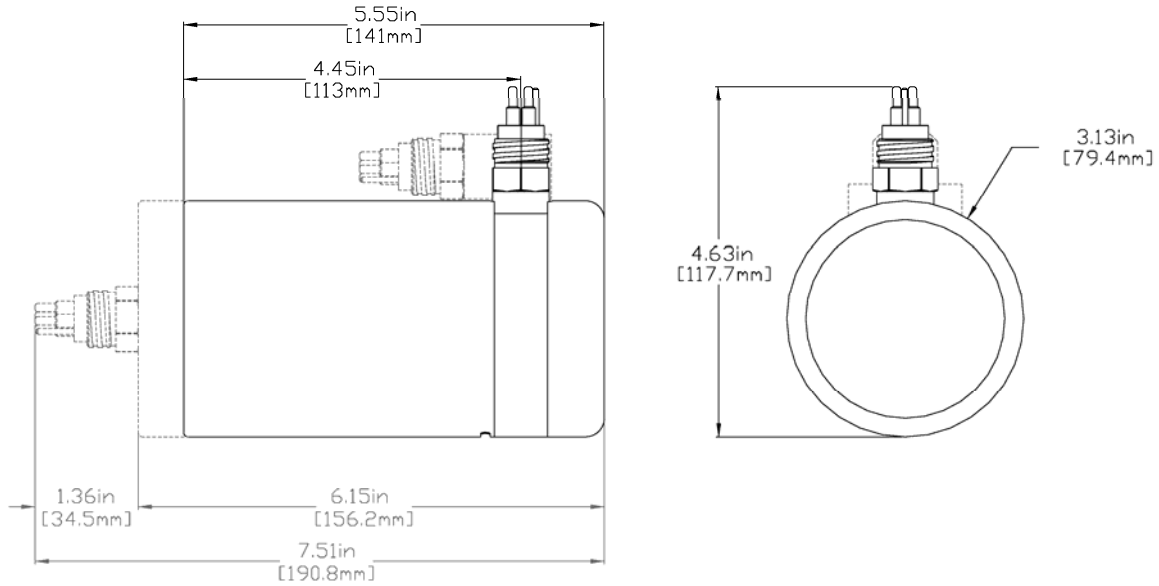

| <b>ORDERING INFORMATION:</b> |          |             |
|------------------------------|----------|-------------|
| <b>1000 m UNIT</b>           | Standard | 881-000-543 |
| End mount connector          | Option   | -009        |
| Right angle connector        | Option   | -010        |
| IP Address*                  | Option   | -020        |

\*Note: Standard IP Address is 192.168.0.5  
 A different IP Address may be specified upon ordering.

Product and company names listed are trademarks or trade names of their respective companies.