

## IMAGENEX SPORTSCAN

### APPLICATIONS:

- Underwater Archaeology
- Sunken Timber Recovery
- Search & Recovery
- Surveying
- Law Enforcement Work
- Scientific Research
- Environmental Survey

### FEATURES:

- Very user friendly
- Lightweight and extremely portable
- Inexpensive
- 23 m (75') tow cable included
- High resolution
- Up to 240 m (800') total coverage
- GPS interface
- Speed correction
- Height and length measurements
- 4 user selectable colour tables
- XTF Conversion program (optional)

The Imagenex SportScan is an affordable dual channel, high-resolution, digital side-scan sonar geared toward the sport diving market. Operate the SportScan directly from your laptop or desktop PC. All that is needed is a 12 VDC power source. Connect a GPS receiver for latitude and longitude coordinates.



<b>HARDWARE SPECIFICATIONS:</b>	
<b>FREQUENCY</b>	330 kHz or 330 / 800 kHz
<b>TRANSDUCER</b>	One transducer per side, tilted down 20°
<b>TRANSDUCER BEAM WIDTH</b>	330 kHz: 1.8° x 60° 800 kHz: 0.7° x 30°
<b>RANGE RESOLUTION</b>	Both sides displayed: Range scale ÷ 250 Single side displayed: Range scale ÷ 500
<b>MAX. OPERATING DEPTH</b>	30 m (100')
<b>MAX. CABLE LENGTH</b>	60 m (200')
<b>INTERFACE</b>	RS-232 serial interface @ 115.2 kbps
<b>CONNECTOR</b>	Wet mateable (Impulse LPMBH-4-MP)
<b>POWER SUPPLY</b>	10 – 16 VDC at 300 mA max.
<b>DIMENSIONS</b>	114 mm (4.5") diameter x 833 mm (32.8") length
<b>WEIGHT: In Air</b>	4.5 kg (10 lbs)
<b>In Water</b>	1.2 kg (2.7 lbs) not including ballast
<b>BALLAST</b>	Standard diver belt weights (readily available at dive shops)
<b>MATERIALS</b>	Polyurethane & 6061-T6 Aluminum
<b>FINISH</b>	Clear anodized

<b>SOFTWARE SPECIFICATIONS:</b>	<b>Win881ss.exe</b>
<b>WINDOWS™ OPERATING SYSTEM</b>	Windows™ XP, Vista, 7, 8, 10
<b>MODES</b>	Side Scan
<b>RANGE SCALES</b>	15 m, 30 m, 60 m, 90 m, and 120 m (50', 100', 200', 300', and 400')
<b>FILE FORMAT</b>	(filename).81s
<b>GPS INPUT (4800, N, 8, 1) NMEA 0183 FORMATS:</b>	GLL, GGA, VTG, RMC
<b>RECOMMENDED MINIMUM COMPUTER REQUIREMENTS:</b>	100 MHz Pentium 16 MB RAM 1 GB Hard Disk 800 x 600 x 256 colour graphics

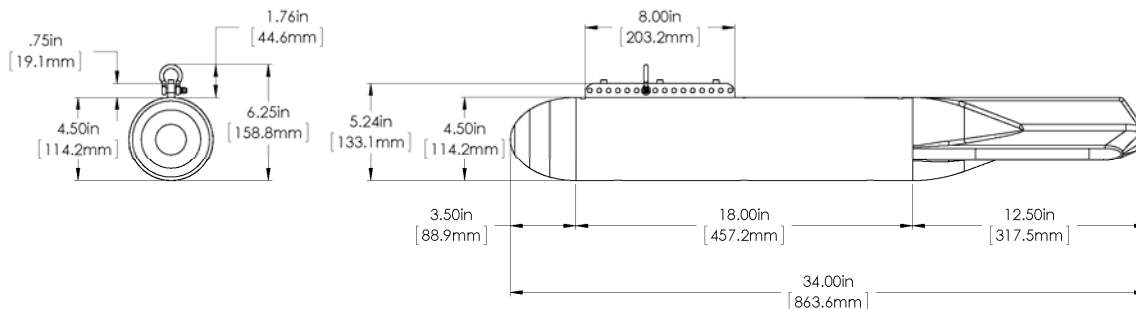

<b>ORDERING INFORMATION:</b>		
<b>30 m unit w / 23 m SportScan tow cable</b>	Standard	881-000-150
330 / 800 kHz	Option	-005
60 m (200') SportScan tow cable	Option	-017
XTF Converter (Imagenex .81s to XTF)	Option	-019

Product and company names listed are trademarks or trade names of their respective companies.