



# IMAGENEX MODEL 881A DIGITAL MULTI-FREQUENCY IMAGING SONAR

## APPLICATIONS:

- ROV, AUV, & UUV
- Offshore Oil & Gas
- Sunken Timber Recovery
- Diving Support
- Surveying
- Search & Recovery
- Inspection
- Underwater Archaeology
- Scientific Research

## FEATURES:

- Programmable
- Multi-frequency
- High performance
- Lower cost
- Low power
- Simple set-up and installation
- Digital telemetry
- Full scale range from 1 m to 200 m
- Compact size
- Communication format available to user

Now with Multi-frequency Sonar, operators can generate highly detailed full-scale images with just one unit. The 881A is a programmable multi-frequency digital imaging sonar that you can operate using default frequency settings or customize the configurations for your own situation. High performance, lower cost, low power and simple set-up and installation, make this sonar perfect for the largest ROV's to the smallest inspection ROV's, plus AUV or UUV applications.



| <b>HARDWARE SPECIFICATIONS:</b>                |  |
|--|--|
| <b>FREQUENCY</b>                               | 310 kHz, 675 kHz, or 1 MHz (default settings)<br>-Other frequencies can be selected through programmable software configurations<br>(Tunable from 280 kHz to 1.1 MHz in 5 kHz steps) |
| <b>TRANSDUCER</b>                              | Imaging type, fluid compensated  |
| <b>TRANSDUCER BEAM WIDTH</b>                   | 310 kHz: 4° x 40°<br>675 kHz: 1.8° x 20°<br>1 MHz: 0.9° x 10°  |
| <b>RANGE RESOLUTION</b>                        | 1 m – 4 m: 2 mm (0.08")<br>5 m & up: 10 mm (0.4")  |
| <b>MIN. DETECTABLE RANGE</b>                   | 150 mm (6")  |
| <b>MAX. OPERATING DEPTH</b>                    | 1000 m and<br>3000 m available   |
| <b>MAX. CABLE LENGTH</b>                       | 1000 m on typical twisted shielded pair (RS-485)   |
| <b>INTERFACE</b>                               | RS-485 serial interface @ 115.2 kbps (or optional RS-232)  |
| <b>CONNECTOR</b>                               | Side mounted, four conductor, wet mateable<br>(Subconn MCBH4M-AS)<br>Optional right angle or end mount connector   |
| <b>POWER SUPPLY</b>                            | 20 – 36 VDC at less than 5 Watts   |
| <b>DIMENSIONS<br/>(for both depth ratings)</b> | 79.4 mm (3.125") diameter x<br>182 mm (7.125") length  |
| <b>WEIGHT: In Air</b>                          | 1000 m unit: 1.5 kg (3.3 lbs)<br>3000 m unit: 2 kg (4.4 lbs)   |
| <b>In Water</b>                                | 1000 m unit: 0.6 kg (1.3 lbs)<br>3000 m unit: 1.1 kg (2.4 lbs)   |
| <b>MATERIALS</b>                               | 1000 m unit: 6061-T6 Aluminum & Polyurethane<br>3000 m unit: Titanium, Polyurethane & 300 series stainless steel   |
| <b>FINISH</b>                                  | Hard Anodize   |

| <b>SOFTWARE SPECIFICATIONS:</b>                           | <b>Win881A.exe</b>  |
|---|---|
| <b>WINDOWS™ OPERATING SYSTEM</b>                          | Windows™ XP, Vista, 7, 8, 10  |
| <b>MODES</b>  | Sector, Polar and Side Scan   |
| <b>RANGE SCALES</b>                                       | 1 m, 2 m, 3 m, 4 m, 5 m, 10 m, 20 m, 30 m, 40 m,<br>50 m, 60 m, 80 m, 100 m, 150 m, 200 m |
| <b>TRAIN ANGLES</b>                                       | Continuous rotation, 3° increments  |
| <b>SECTOR SIZE:<br/>SECTOR MODE<br/>POLAR MODE</b>        | 0° – 180°, 3° increments<br>0° – 357°, 3° increments, or Continuous rotation              |
| <b>STEP SIZES</b>   | Slow (0.3°), Medium (0.6°), Fast (0.9°), Faster (1.2°),<br>Fastest (2.4°)                 |
| <b>GRID TYPES</b>   | Polar and rectangular   |
| <b>FILE FORMAT</b>  | (filename).81a  |
| <b>RECOMMENDED<br/>MINIMUM COMPUTER<br/>REQUIREMENTS:</b> | 100 MHz Pentium<br>16 MB RAM<br>1 GB Hard Disk<br>800 x 600 x 256 colour graphics         |

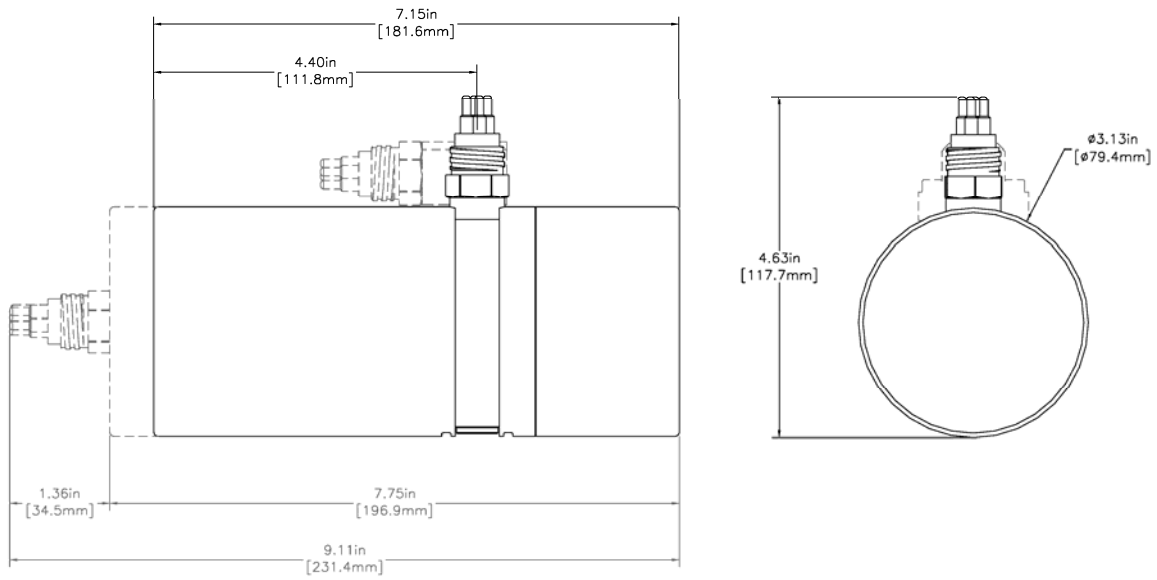

| <b>ORDERING INFORMATION:</b>              |          |             |
|---|----------|-------------|
| <b>1000 m UNIT</b>                        | Standard | 881-000-400 |
| <b>3000 m UNIT</b>                        | Standard | 881-000-401 |
| RS-232                                    | Option   | -006        |
| End mount connector                       | Option   | -009        |
| Right angle connector                     | Option   | -010        |
| Interface source code in "C" (TEST881A.C) | Option   | -018        |

Product and company names listed are trademarks or trade names of their respective companies.